

LEGEND:

— SITE OUTLINED IN RED.

□ AREA TO BE TAKEN IN CHARGE BY LOCAL AUTHORITY. AREA = 61,976.70m²

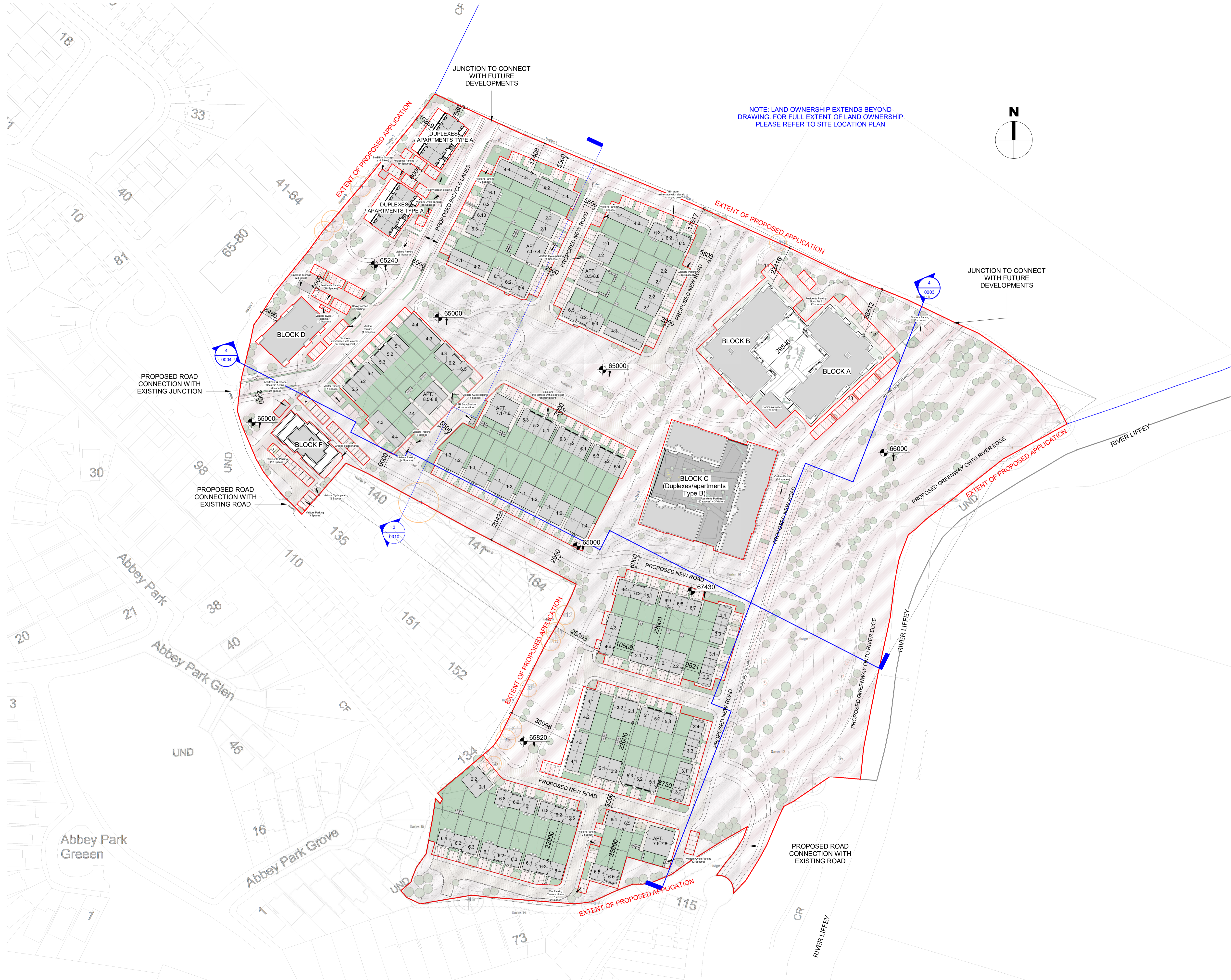

NOTE: LAND OWNERSHIP EXTENDS BEYOND DRAWING. FOR FULL EXTENT OF LAND OWNERSHIP PLEASE REFER TO SITE LOCATION PLAN

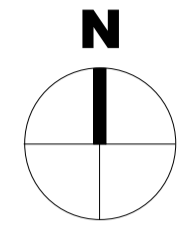

Rev	Date	Description	Issued By
P01	14/12/2020	Issue for Planning	VM

Project Stage
Planning

Client:
Westar Investments Ltd.

Project:
Residential Development @ Capdoo Clane

Drawing Title:
Proposed site plan - Taking In Charge

Drawn	Checked	Paper Size	Scale	Date
VM	J.M	A1	1:1000 @A1	14/12/2020

Project No.	Drawing No.	Classification	Revision
PE20057	2040		P01

File Name:
PE20057-CWO-ZZ-DR-A-2040

Status:
S1 - Suitable For Coordination

